

LANDSCAPE ARCHITECTURE

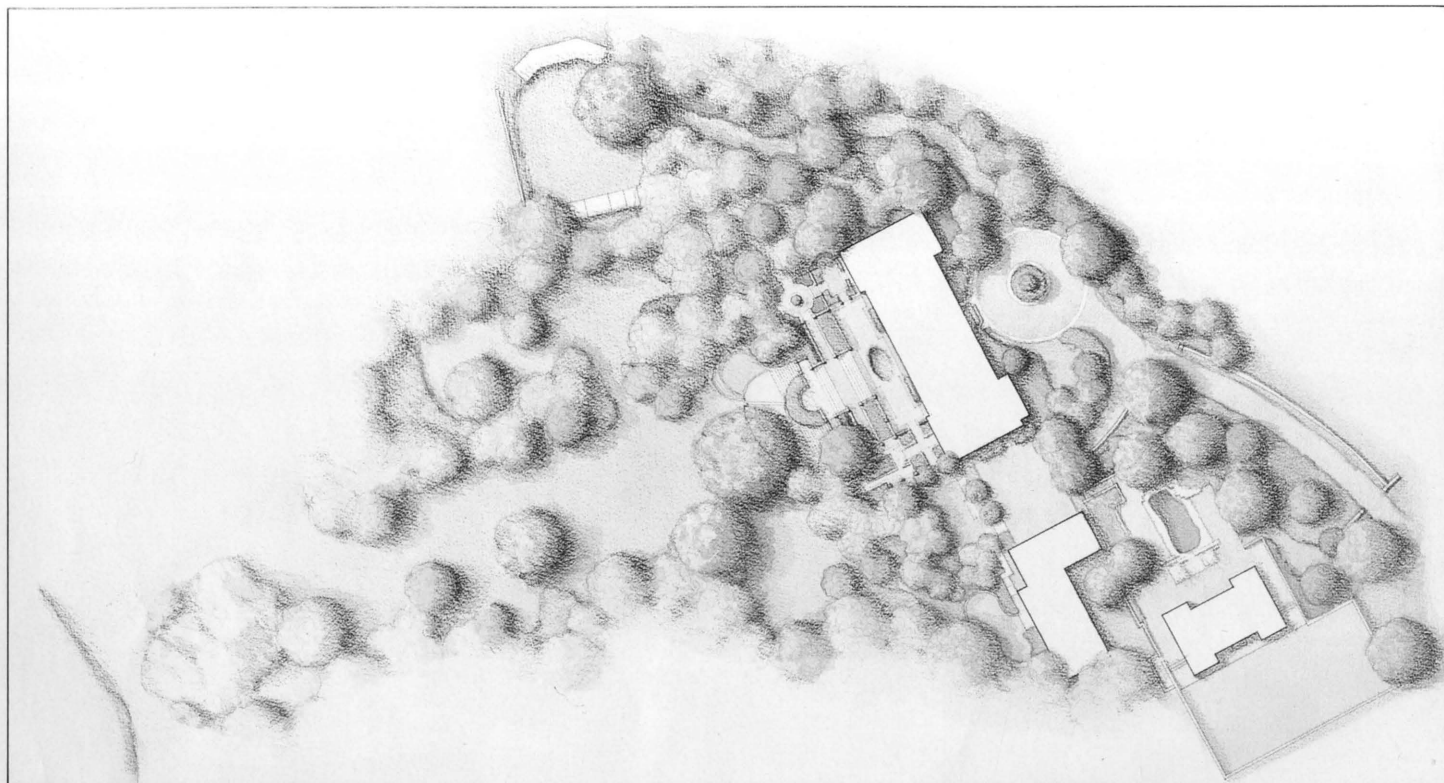

58

50 COVER STORY

Villas and estates

52 Gardening in the First Quintile

by Phoebe Cutler

Untapped opportunities exist in landscape design for the elite

56 Stone Villa

by Tom Jenkins

Colorado estate evokes ancient Mediterranean villas

58 Thoroughbred Landscape

by Nancy Levinson

Kentucky horse farm responds to the land's contours

60 Steep Solutions

by Virginia Greiner

Two northern Virginia properties turn steep sites to advantage

64 Reconstructed Grandeur

by Nancy Levinson

Restoration of Stan Hywet Hall reflects meticulous research

66 Two By Bye

by Jory Johnson

A. E. Bye's minimalist aesthetic, in two pastoral settings

70 LA Forum

by J. William Thompson

Pondering the social value of estate design

136 Prospect

by Dan Rose

In time, large private landholdings do serve the public weal

82

PROFILE*by J. William Thompson*

John Lyle integrates development and sustainable ecosystems

DEPARTMENTS

8	Letters	95	Reviews	135	Reader Service Index
22	News	97	Buyer's Guide		
38	Global Landscape	134	Classifieds		

ON THE COVER: Estate on an island in Long Island Sound designed by Morgan Wheelock, Inc. Photograph by Ann Fuller.

Landscape Architecture (ISSN 0023-8031) is published monthly by the American Society of Landscape Architects, copyright 1991. Second-class postage paid at Washington, DC, and additional mailing offices. **SUBSCRIPTIONS:** U.S.: \$38/year, \$60/2 years. Canada and foreign surface mail: \$65/year, \$120/2 years. Airmail: \$117/year, \$230/2 years. Students: \$28/year. Single copies \$6. Send U.S. funds to Landscape Architecture, 4401 Connecticut Ave., NW, 5th Floor, Washington, DC 20008-2302. Telephone (202) 686-2752. ASLA members: \$19 of dues is designated for magazine subscription. Please direct inquiries to Membership Department.

POSTMASTER: Send address changes to *Landscape Architecture*, 4401 Connecticut Ave., NW, 5th Floor, Washington, DC 20008-2302.